

Copper Mechanical Connectors

For stranded, solid, flexible and other types of cables.

LOCKTITE® Tandem-Type Two-Hole NEMA-Drilled Lugs

- Each lug takes a range of wire sizes
- Bolt holes and spacings listed are standard
- For use with code copper conductor (600V)



CAT. NO.	CABLE SIZE	DIMENSIONS (IN.)							
		G	A	B	C	D	J	F	H
32007TL	4 to 1	3/8	3 3/16	2	3/4	7/32	2 9/32	7/16	1
32009TL	1 to 2/0	1/2	4 15/16	3	1	1/4	1 3/32	9/16	1 3/4
32011TL	2/0 to 4/0	1/2	5 5/8	3	1	9/32	1 5/16	9/16	1 3/4
32013TL	4/0 to 300	1/2	5 5/8	3	1 1/16	5/16	1 9/16	9/16	1 3/4
32015TL	300 to 500	1/2	6 11/32	3 1/2	1 3/8	1 1/32	—	5/8	1 3/4
32017TL	500 to 750	1/2	6 23/32	3 1/2	1 3/4	1 3/32	2 1/8	5/8	1 3/4

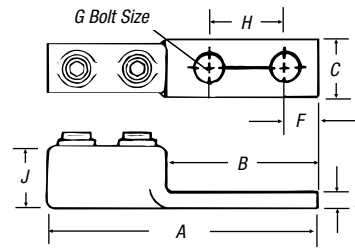

For easy installation in hard-to-reach places.

LOCKTITE® Ground Bus Taps for 1/4" Copper Bus Bar

- Eliminate the need to drill holes in the ground bus
- Can be placed quickly at any location
- Install with only a key wrench
- Standard LOCKTITE® lug grip securely holds tapping cable
- For use with code copper conductor (600V)



CAT. NO.	WIRE SIZE (IN.)	DIMENSIONS (IN.)		
		A	B	BUS THICKNESS
31207	8 to 4	2 1/4	1 3/4	1/4
31208	4 to 1	2 5/16	1 3/4	1/4
31209	1 to 2/0	2 3/4	1 3/4	1/4
31210	2/0 to 4/0	2 3/4	1 3/4	1/4
31211	4/0 to 300	2 3/4	1 3/4	1/4
31212	300 to 500	3	1 3/4	1/4

For torque requirements, see page F-188.

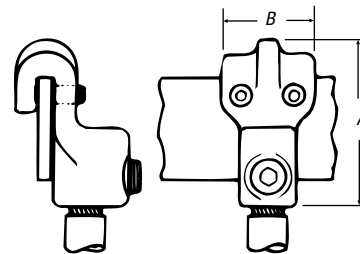

LOCKTITE® Pigtail Connectors

- For use with code copper conductor (600V)



CAT. NO.	SIZE	CABLE FIG.	DIMENSIONS (IN.)	
			A	J
31305	10 to 8	A	1/2	1 1/32
31307	8 to 6	A	3/4	2 7/32
31309	6 to 4	B	7/8	1 1/32
31311	4 to 2	B	1 1/16	1 1/4
31313	1 to 2/0	B	1 3/16	1 1/2
31315	2/0 to 4/0	B	1 1/16	1 29/32

For torque requirements, see page F-188.

Note: To order with hex head screws (available on all except 10–8 code size), add prefix H to catalog number.

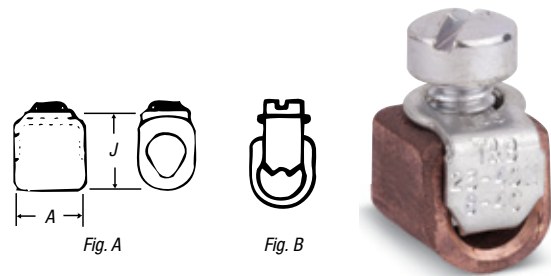

Copper Mechanical Conductors

Each connector accommodates a wide range of conductor sizes.

LOCKTITE® Stud Connectors

- Fast, simple installation
- Convenient pigtail is easy to tape
- To order with hex head screws, add prefix H to catalog number
- Standard tapping shown in diagrams
- Other tapping to meet specific requirements available on request
- For use with code copper conductor (600V)



Type MS

Type FL

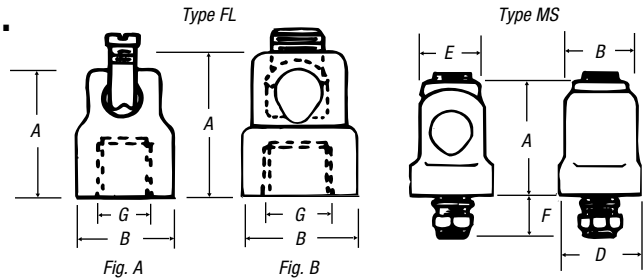

Male — Type MS

CAT. NO.	CABLE SIZE	DIMENSIONS (IN.)					STUD SIZE (IN.)
		A	B	D	E	F	
31007-T	4 to 1	1 $\frac{3}{8}$	2 $\frac{5}{32}$	$\frac{7}{8}$	$\frac{5}{8}$	$\frac{3}{4}$	$\frac{3}{8}$ -16
31009-T	1 to 2/0	1 $\frac{3}{8}$	$\frac{7}{8}$	1	$\frac{3}{4}$	$\frac{3}{4}$	$\frac{3}{8}$ -16
31011-T	2/0 to 4/0	1 $\frac{3}{8}$	1 $\frac{1}{16}$	1 $\frac{1}{16}$	$\frac{7}{8}$	1	$\frac{1}{2}$ -13
31013-T	4/0 to 300	1 $\frac{3}{8}$	1 $\frac{3}{16}$	1 $\frac{3}{8}$	1 $\frac{1}{16}$	1	$\frac{1}{2}$ -13
31015-T	300 to 500	2 $\frac{5}{32}$	1 $\frac{5}{16}$	1 $\frac{1}{2}$	1 $\frac{1}{4}$	1	$\frac{1}{2}$ -13

Female — Type FL

CAT. NO.	CABLE SIZE	FIG.	DIMENSIONS (IN.)		
			G	A	B
31262 [†]	8 to 4	A	$\frac{3}{8}$ -16	1 $\frac{1}{16}$	$\frac{5}{8}$
31263	4 to 1	B	$\frac{3}{8}$ -16	1 $\frac{15}{32}$	$\frac{3}{4}$
31265	4 to 1	B	$\frac{1}{2}$ -13	1 $\frac{15}{32}$	$\frac{3}{4}$
31267	2/0 to 4/0	B	$\frac{1}{2}$ -13	2 $\frac{3}{16}$	1 $\frac{3}{16}$

[†]With Filister Head Screw.

Designed to grip cable firmly between its strong body and serrated copper tongue.

LOCKTITE® LUG-IT One-Hole Lugs, Offset Tongue

- Double laps at top give greater thread strength and lock screw when tightened
- Copper tongue makes a low-resistance terminal
- For use with code copper conductor(600V)

T&B Recommended Tightening Torque for Copper Connections

SIZE OF CONDUCTOR RANGES	WRENCH TORQUE IN.-LBS.	SCREW DRIVER TORQUE IN.-LBS.
14 to 8	—	20
8 to 4	—	35
4 to 1	125	—
1 to 2/0	150	—
2/0 to 4/0	200	—
4/0 to 300	250	—
300 to 500	300	—
500 to 750	300	—
750 to 1,000	400	—

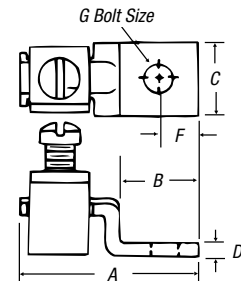

CAT. NO.	CABLE SIZE	DIMENSIONS (IN.)					
		G	A	B	C	D	F
35301	14 to 6	#10	1 $\frac{3}{16}$	$\frac{1}{2}$	$\frac{3}{8}$.064	$\frac{7}{32}$
35401	8 to 2	$\frac{1}{4}$	1 $\frac{1}{16}$	$\frac{5}{8}$	$\frac{1}{2}$.081	$\frac{1}{4}$
35501 ^{**}	4 to 2/0	$\frac{1}{4}$	1 $\frac{13}{16}$	1 $\frac{3}{16}$	$\frac{3}{4}$.101	$\frac{3}{8}$
35601 ^{**}	1/0 to 4/0	$\frac{3}{8}$	2 $\frac{1}{32}$	1 $\frac{3}{32}$	1	.128	$\frac{1}{2}$

* Aluminum body.

[†]Hex head bolt.

Add suffix G to above Cat. Nos. for lug connector with green screw for grounding identification.

For torque requirements, see table at left.